

# SUPER DOMINATOR 450 / 450 HD MAINTENANCE SHEET - HOW TO ASSEMBLE

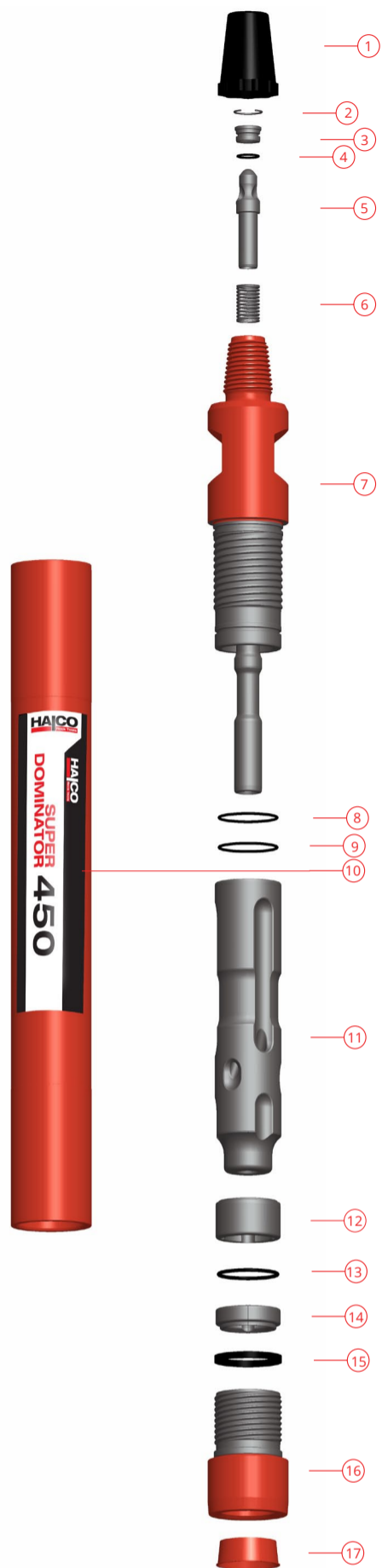

**C.** Insert the Bit Guide Bush (12) into the bottom of the Cylinder (10). Ensure that the flutes are towards the bottom of the cylinder and that it sits up to the step in the cylinder.

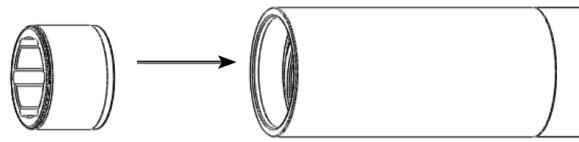

**D.** Insert 'O' Ring (13) into the bottom of the Cylinder (10). Ensure it sits in the groove and up to the Bit Guide Bush (12).

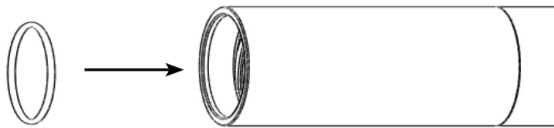

**E.** Fit Chuck Lock Ring (15) onto Chuck (16). Ensure it sits in the appropriate groove.

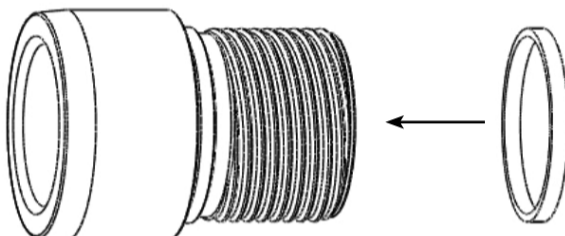

**F.** Grease the threads and fit the Chuck (16) over the Drill Bit. Fit the Bit Retaining Ring (14) over the Drill Bit.

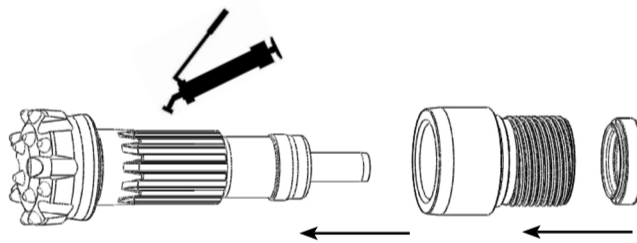

**G.** Grease the threads and screw the Drill Bit, Chuck (16) and Bit Retaining Rings (14) into the bottom of the Cylinder (10) until fully tightened.

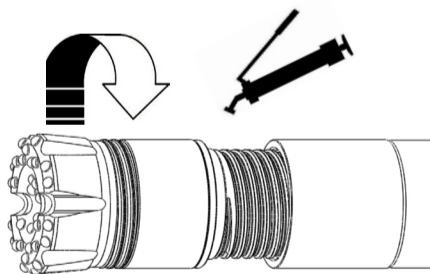

**H.** Coat the Piston (11) liberally with rock oil - minimum 200 centistroke and insert into the top of the Cylinder (10). Ensure it is fitted the right way round as illustrated.

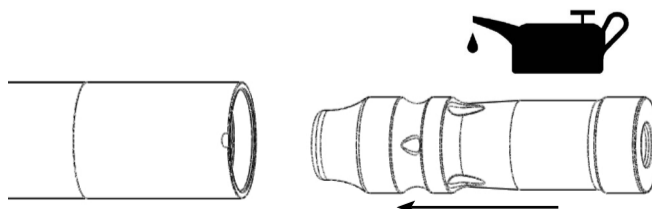

**I.** Fit the 'O' Ring (4) to the N.R.V. Seat (3).

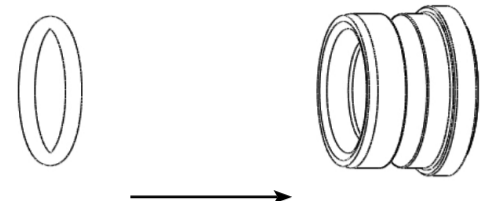

**J.** Insert the N.R.V. Assembly (3-6) into the Top Adaptor (7) and secure with Snap Ring (2).

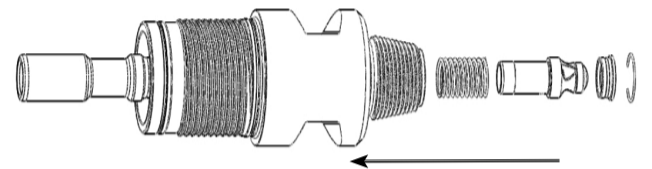

**K.** Fit 'O' Rings (8 & 9) onto the Top Adaptor (7). Ensure that it sits in the appropriate grooves.

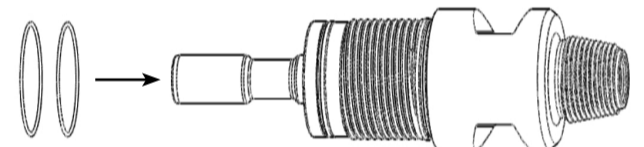

**L.** Grease the threads and screw the Top Adaptor (7) into the Cylinder (10) until fully tightened.

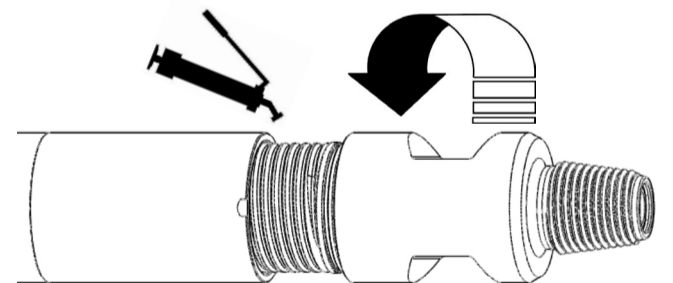

**M.** Depress N.R.V. (5) and pour 1/3 litre of air line oil into the hammer.

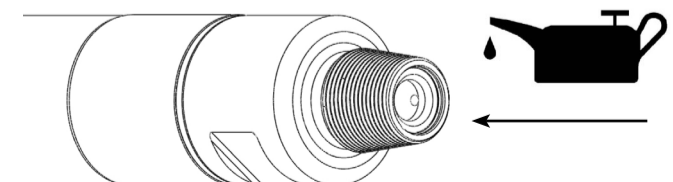

**A.** Before assembly ensure that all components are cleaned, greased and lubricated. Lay out components in the order of the illustration above for ease of identification.



**B.** Secure Cylinder (9) on a bench or suitable stripping equipment. The cylinder is not reversible and the bottom of the hammer is the cylinder end with an internal step and the top of the hammer is the cylinder end with the machined flat.



If you need further assistance, please call us on:  
(0)1422 399900 or email [salesuk@halcorocktools.com](mailto:salesuk@halcorocktools.com)

**HAJCO**  
Rock Tools

# SUPER DOMINATOR 450 / 450 HD MAINTENANCE SHEET - HOW TO DISMANTLE

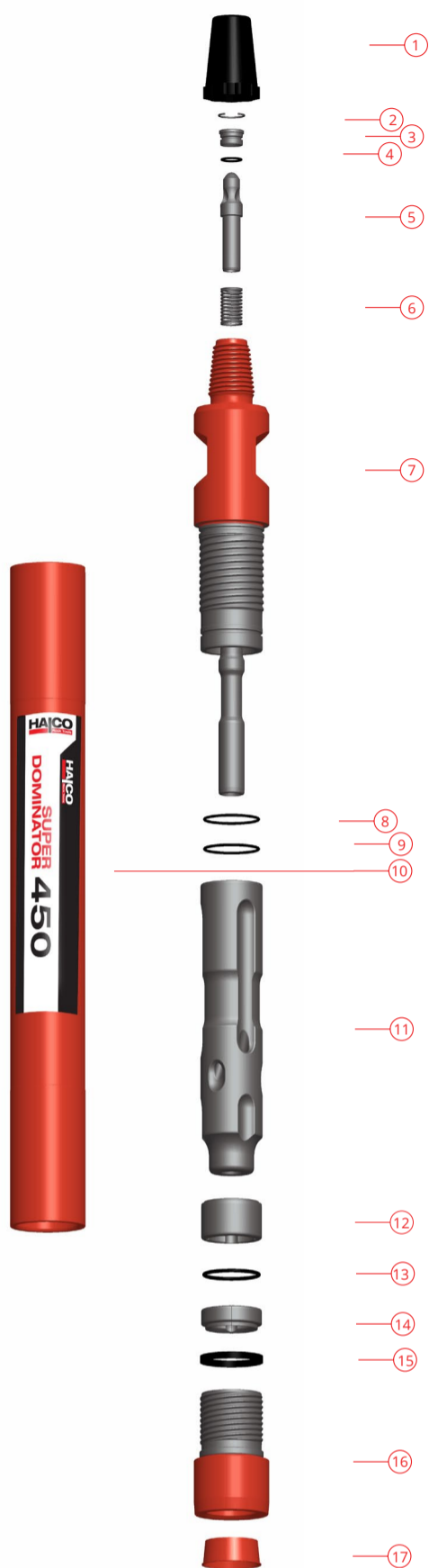

**B.** Break the top joint between the Cylinder (10) and Top Adaptor (7) and bottom joint between Cylinder (10) and Chuck (16).



**H.** Remove the Snap Ring (2) from the Top Adaptor (7).

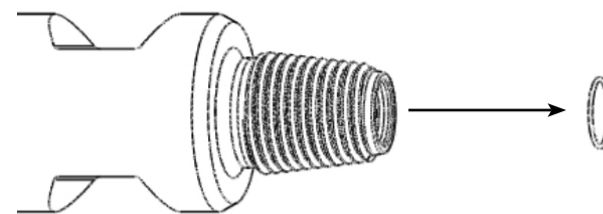

**C.** Unscrew and remove the Drill Bit, Chuck (16) and the Bit Retaining Rings (14) from the Cylinder (10).

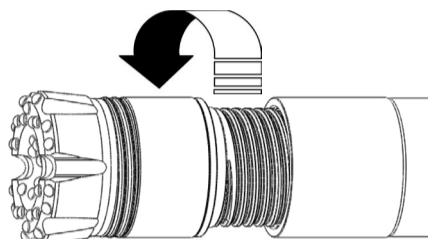

**I.** Remove the N.R.V. Assembly (3-6) from the Top Adaptor (7).

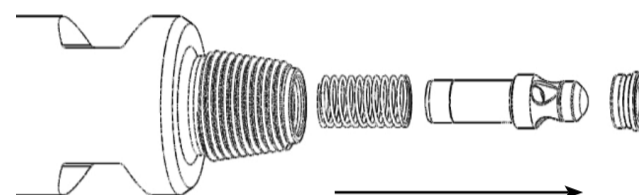

**D.** Remove the Bit Retaining Rings (14) from the Drill Bit and remove the Chuck (16) from the Drill Bit.

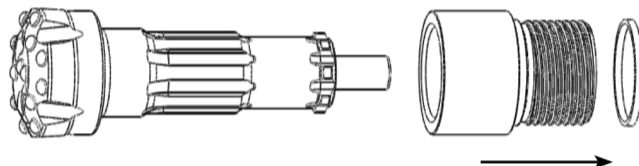

**J.** Remove the O'Ring (4) from the N.R.V. Seat (3).

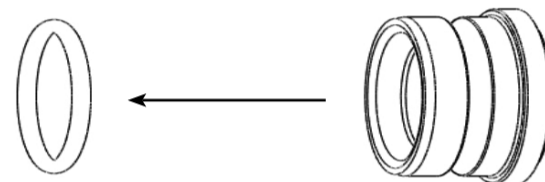

**E.** Remove the Chuck Lock Ring (15) from the Chuck (16).

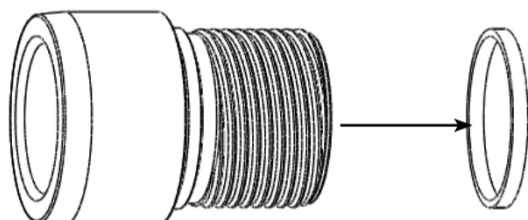

**K.** Unscrew and remove the Top Adaptor (7) from the Cylinder (10).

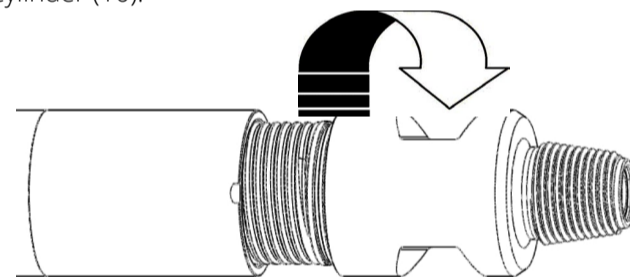

**DO NOT** apply heat or direct impact to the outside of the hammer as this usually damages the equipment.

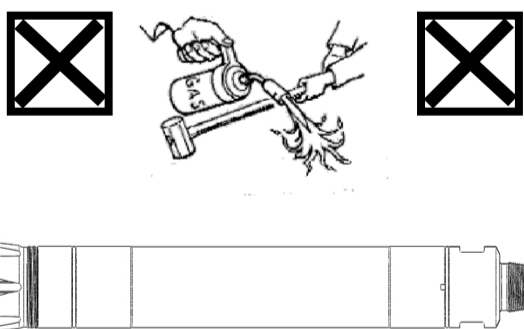

**F.** Remove the 'O' Ring (13) from the Cylinder (10).

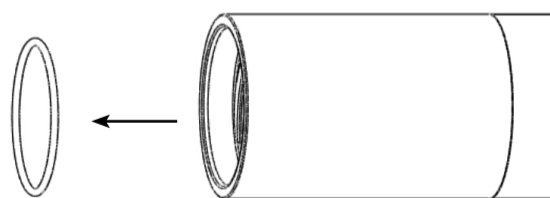

**L.** Remove the 'O' Rings (8 & 9) from the Top Adaptor (7).

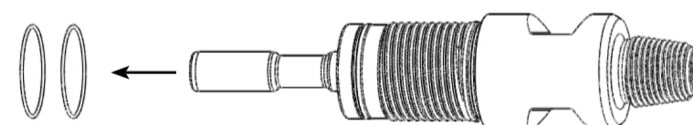

**A.** When dismantling hammers it is essential that cylinders are clamped in the correct position, away from threads, which can be damaged.

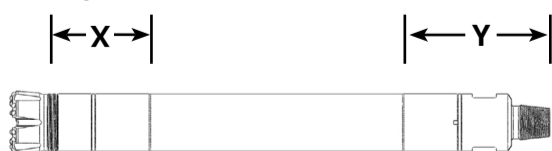

X & Y = DO NOT CLAMP HERE  
X = 130 mm (5.315")  
Y = 300 mm (11.811")

**G.** Remove the Bit Guide Bush (12) from the Cylinder (10).

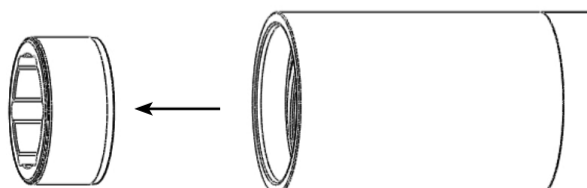

**M.** Remove the Piston (11) from the top adaptor end of the Cylinder (10).

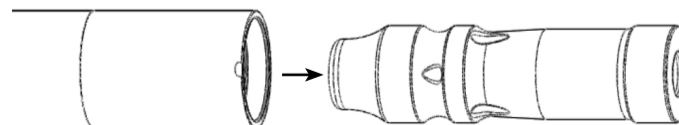

If you need further assistance, please call us on:  
(0)1422 399900 or email [salesuk@halcorocktools.com](mailto:salesuk@halcorocktools.com)

**HAJCO**  
Rock Tools